

D. Hildebeitel

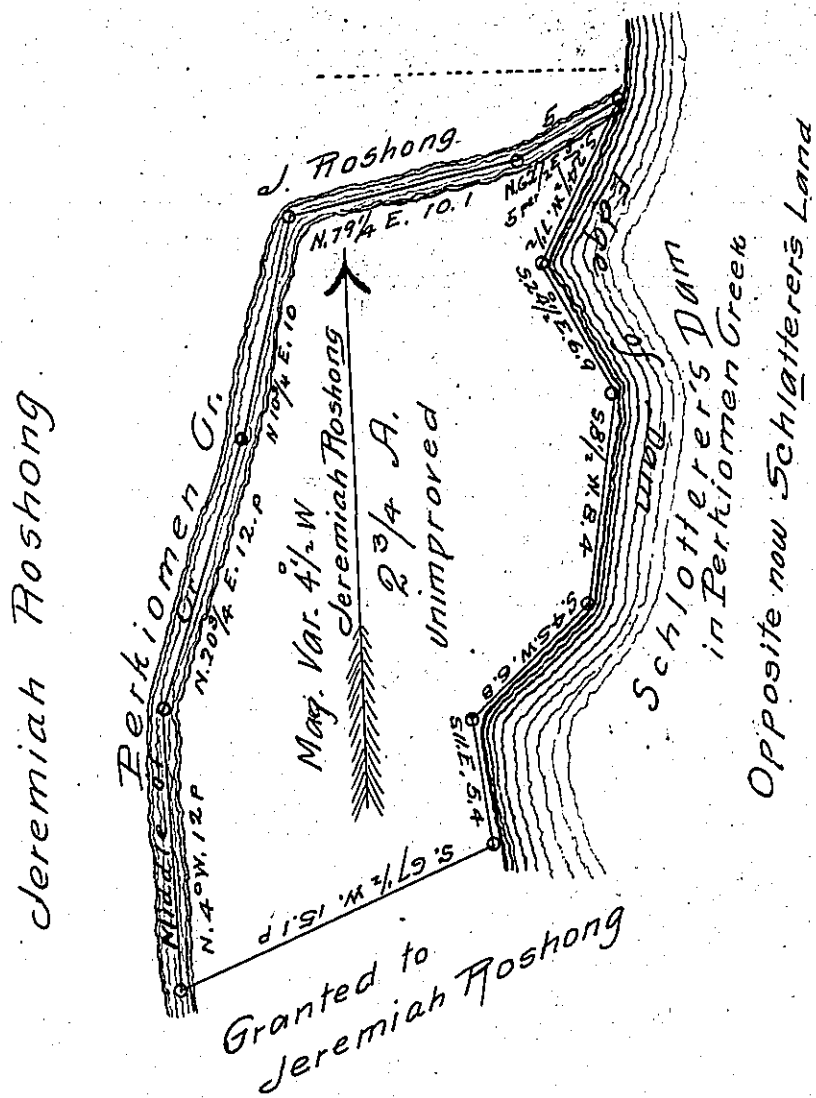

Draft of a Tract of Land situate on the waters of the Perkiomen Creek in the townships of Upper Salford and Frederick in the County of Montgomery Containing 2 3/4 acres with G. p. C. allowances for roads &c. being part of an island formed by said Creek. (Unimproved)

Surveyed the 1st day of January A.D. 1856 on a Warrant dated December 27th 1855 granted to Jeremiah Roshong

E. W. Beans

To J. Porter Brawley Esq.  
Surveyor General

County Surveyor  
Montg: Co

Harrisburgh Pa

IN TESTIMONY that the above is a copy of the original remaining on file in the Department of Internal Affairs of Pennsylvania, made conformably to an Act of Assembly approved the 16th day of February, 1833, I have hereunto set my Hand and caused the Seal of said Department to be affixed at Harrisburgh, this twenty-fifth day of September 1906

*Geo. A. N. Brown*  
Secretary of Internal Affairs